

## TECHNICAL SPECIFICATION

Min. breaking load tension: 500 kN  
Min. breaking load shear: 420 kN

Material: Cast steel

Hot dip galvanized, upper part yellow painted

To be used at 150-gap position with semiautomatic twistlock at opposite container end

Midlock allows to fit a lashing bar to the bottom corner of the upper container

In 'up-side down' position midlock can be also used in 150 deck foundation in combination with manual twistlock or semi-automatic twistlock

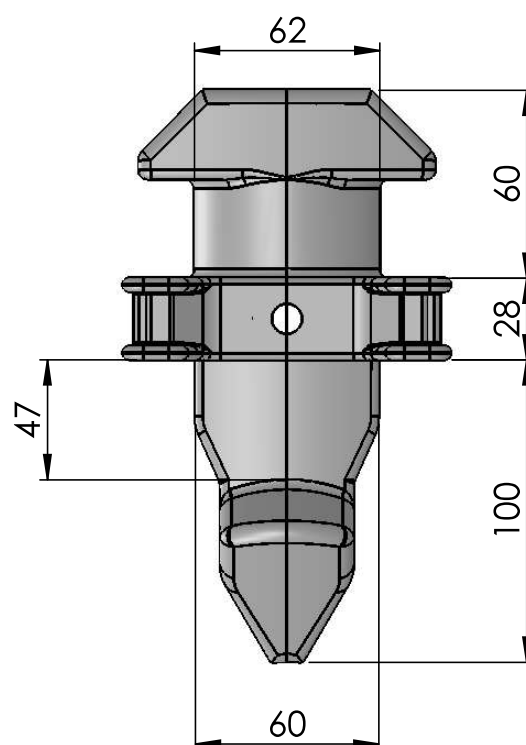

**TEC CONTAINER S.A.**

Tel: + 34 91 302 16 38  
Fax: + 34 91 766 42 79  
teccontainer@teccontainer.com  
<http://www.teccontainer.com>



**MIDLOCK TWISTLOCK**

**CI-15A-1 KRS**